

贵妃型沙发床

操作说明

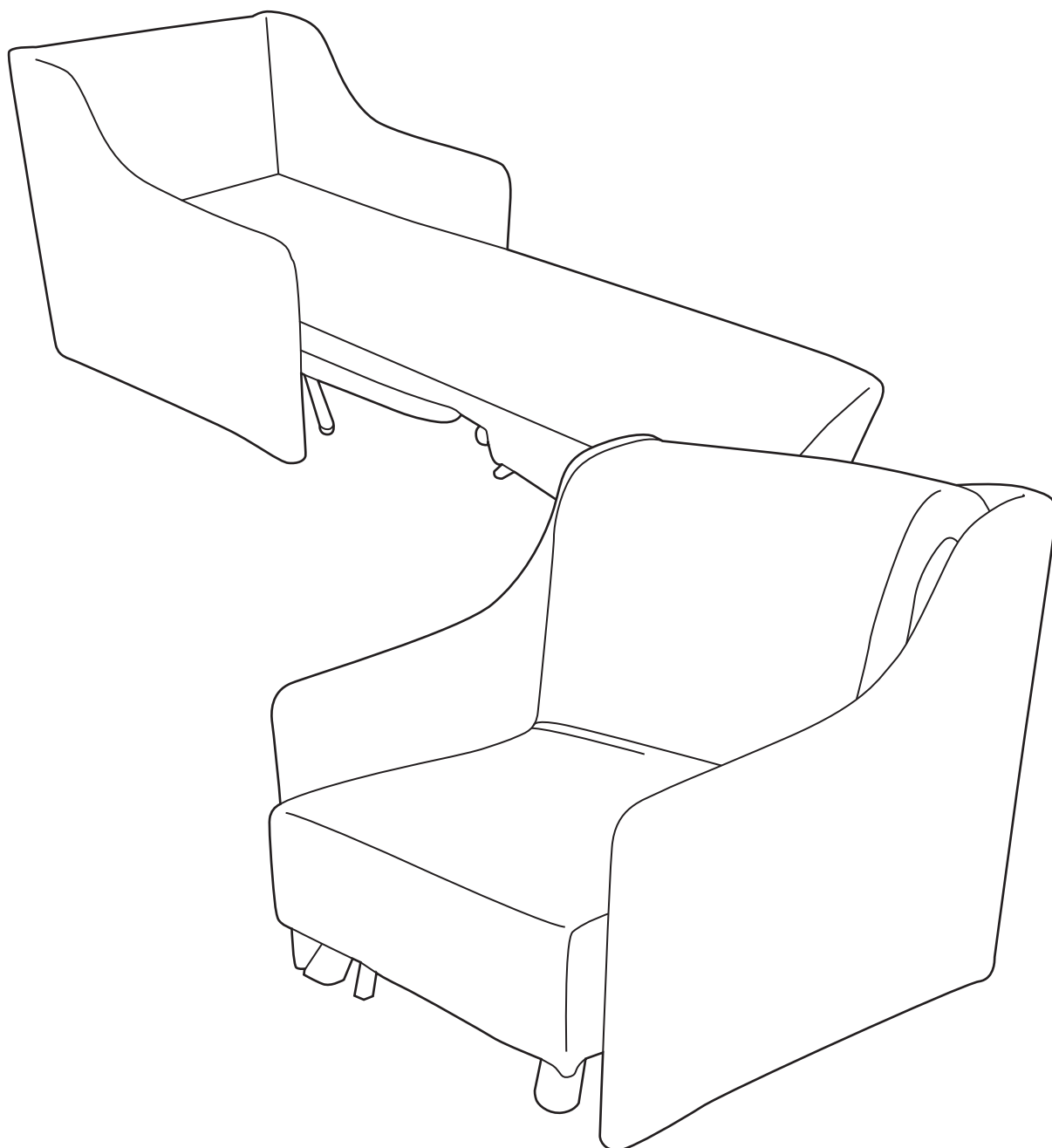

展开操作

①将前框轻微抬起，向后拉

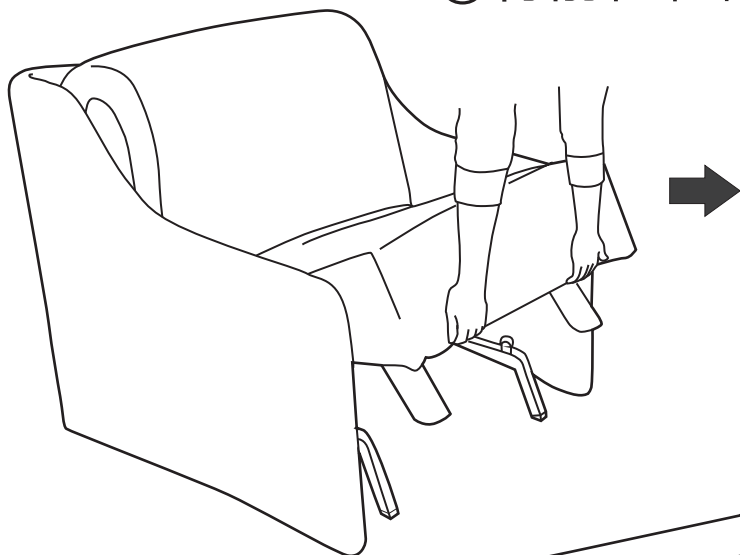

②拉至床面平整

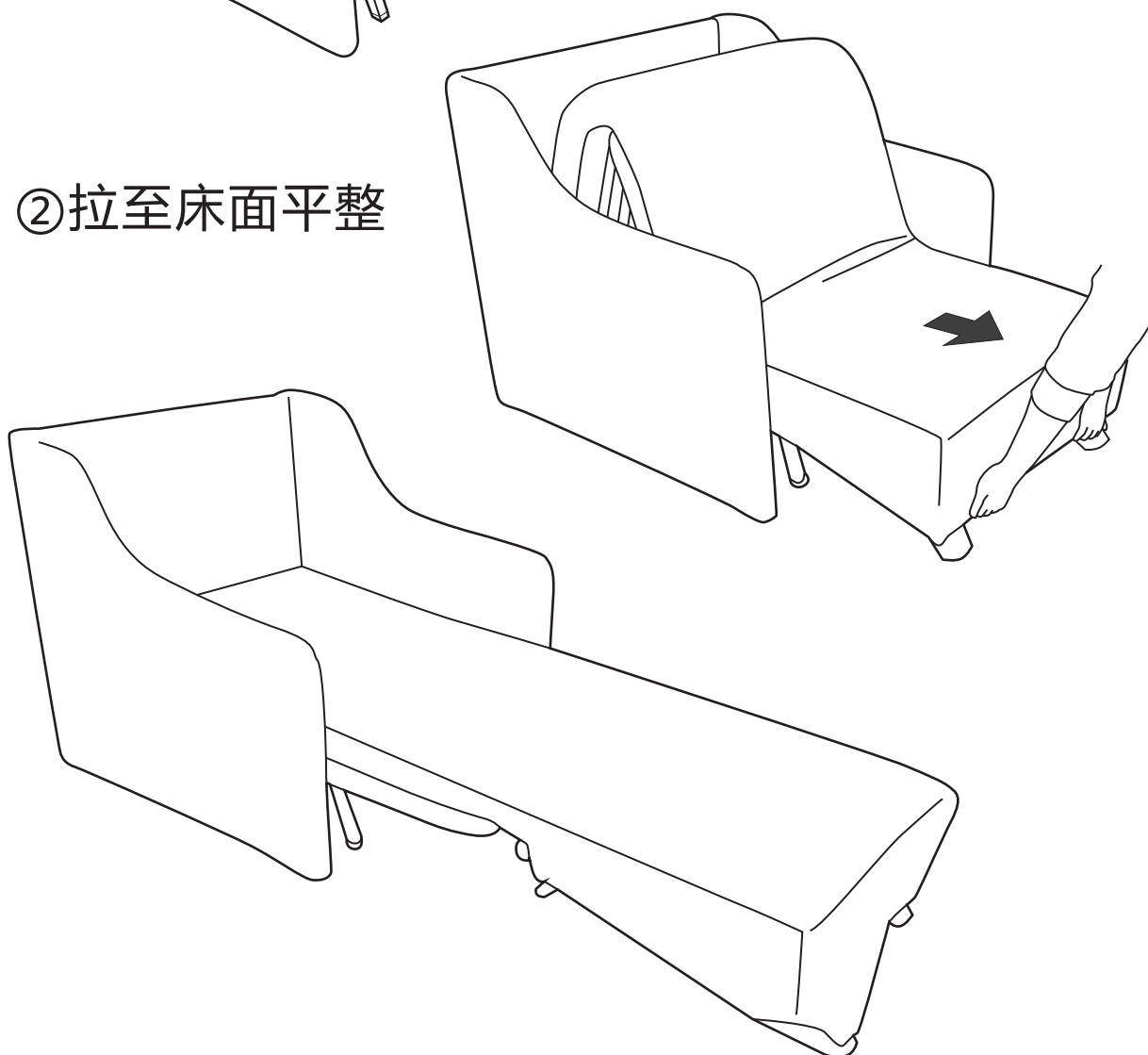

靠背操作

①可将靠背向上抬起至舒适角度

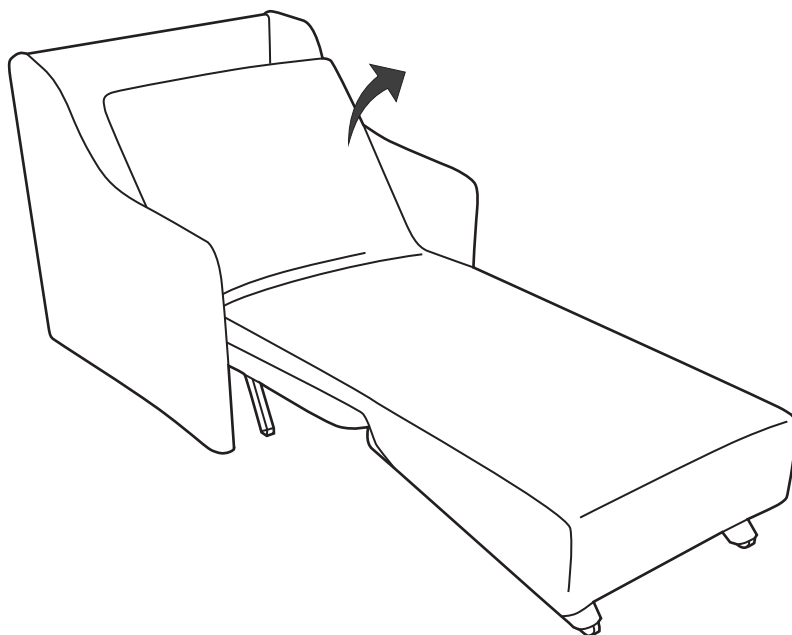

②抬起至最高点(灰色位置)后即可重新放倒

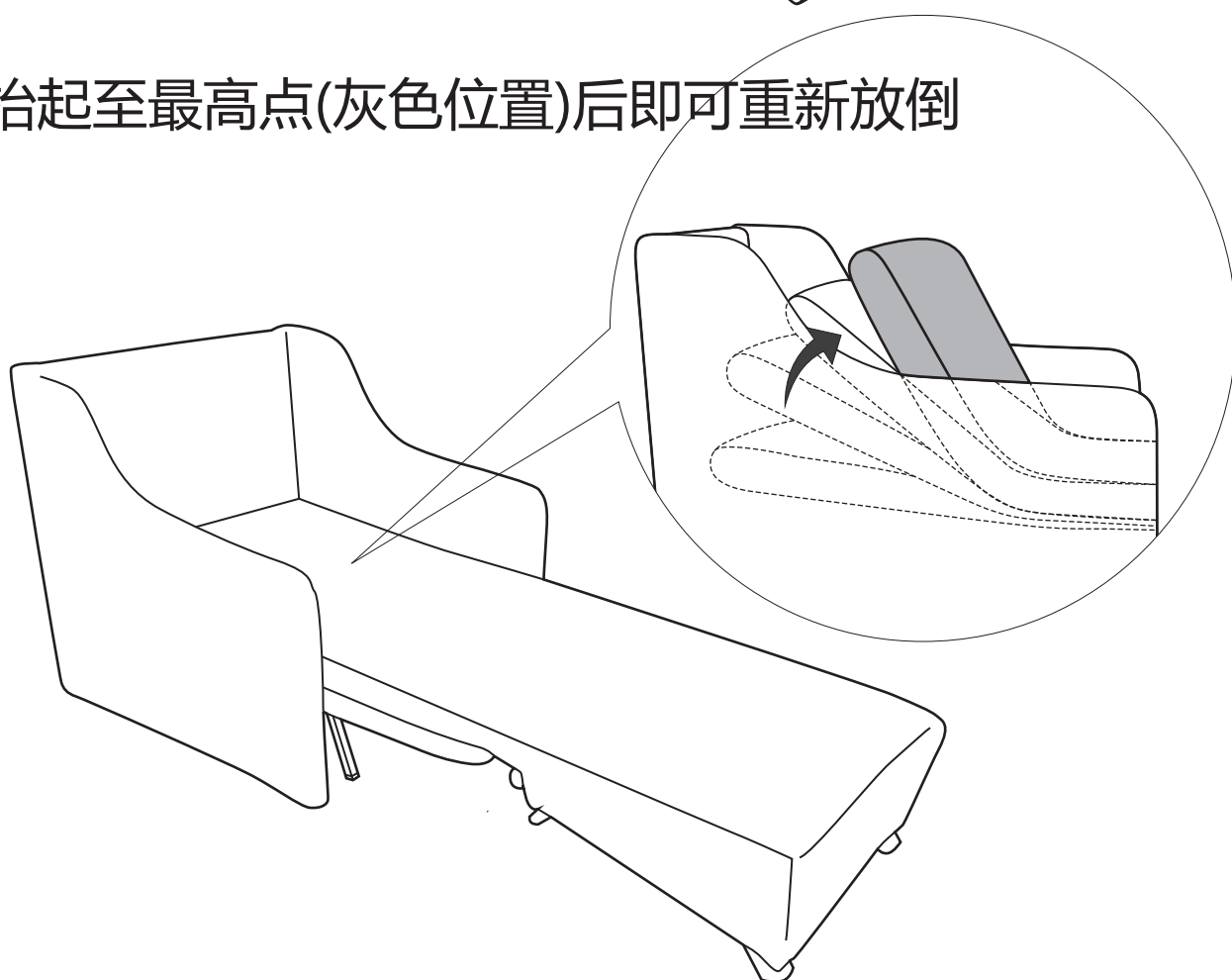

收起操作

① 将前框尽量抬起

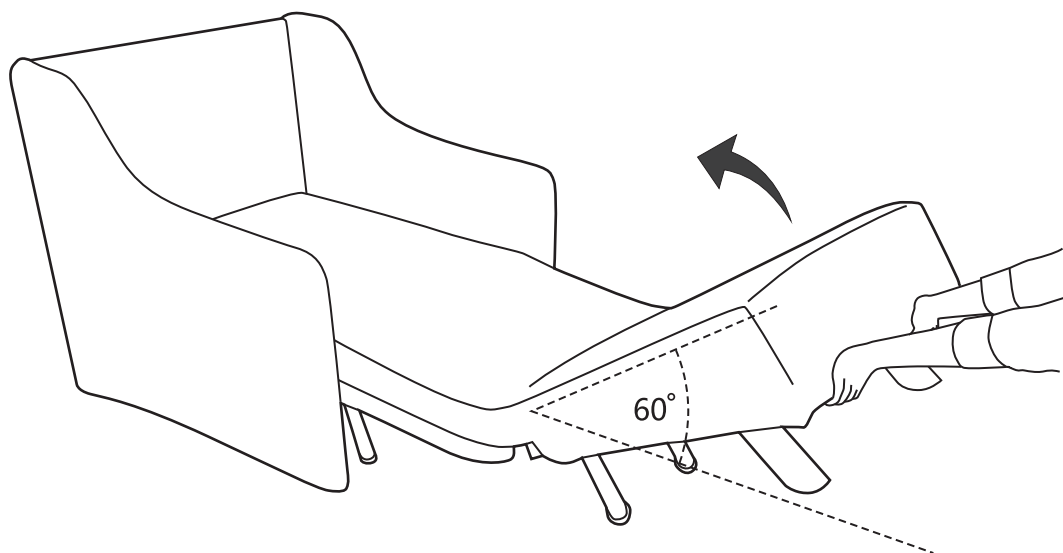

② 抬起约60°后，向下压，中后框自动翘起

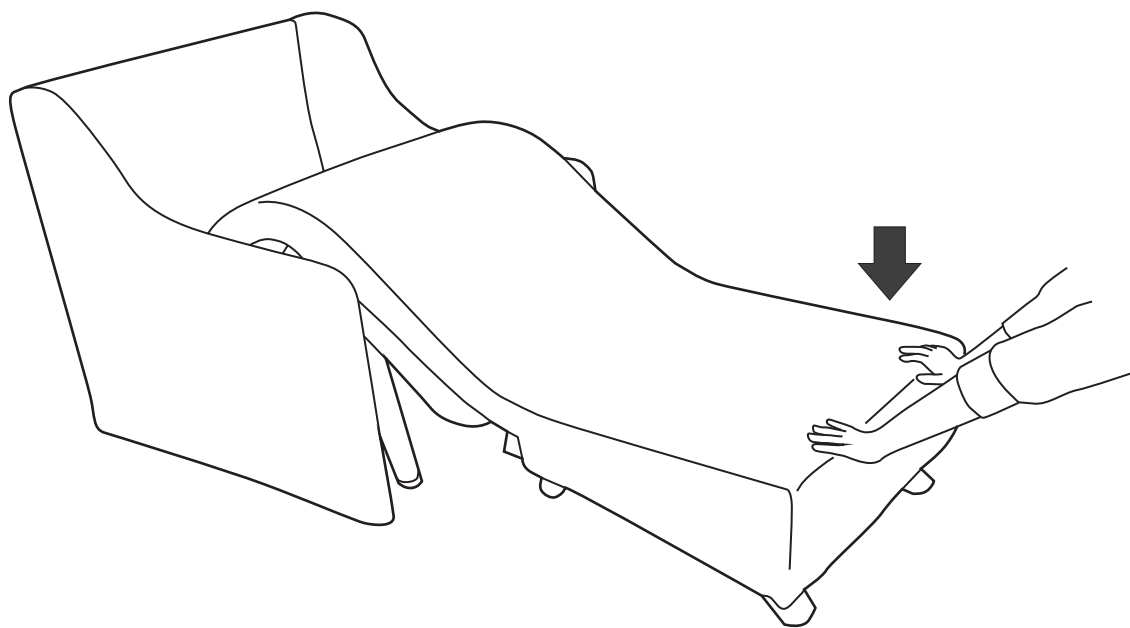

③将前框推到底

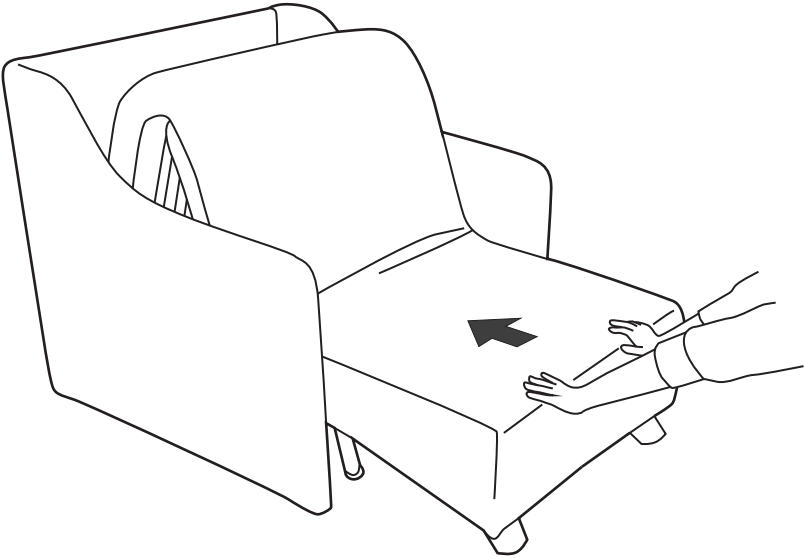

④轻微抬起，前推并放下

